

# MONTHLY UPDATE

News you can use in **30 seconds or less!**

We're proud to support the National Seating & Mobility 2023 Symposium and are looking forward to seeing you in person!

**FEBRUARY 10 - 12**

OMNI Orlando Resort at ChampionsGate  
1500 Masters Blvd., Championsgate, FL 33896

**NATIONAL SEATING & MOBILITY**

**2023 SYMPOSIUM**



★ **Clear Vision. Rooted in Hearts.** ★  
★ **Destined to Win.** ★



## Remember This

Memory seating on TRU-Balance® 4 Power Positioning Systems with anterior tilt offers eight customizable positions.

- Your client can reach power seat functions quickly and independently
- Clients can reposition for functional reach to accomplish ADLs

 [CLICK HERE](#) to watch the video.

## What's the Difference?

Check out our new blog on the differences between TRU-Balance® 3 and TRU-Balance 4 seating systems.

 [CLICK HERE](#) to read more.



## Colors Discontinued

To streamline our color offerings, *Cherry Bomb*, *White Satin* and *Sugar Plum* will be discontinued upon inventory depletion. New product quotes with those colors are no longer being accepted.

## Get Back

New Quantum® backs are now available in eight different options.

- Can be mounted directly to center spine mounting system
- All backs are AFT (Aluminum Flat Top) Series
- Only available on TB3 and TB4 seating systems
- Available in active contour, deep contour and extra deep contour

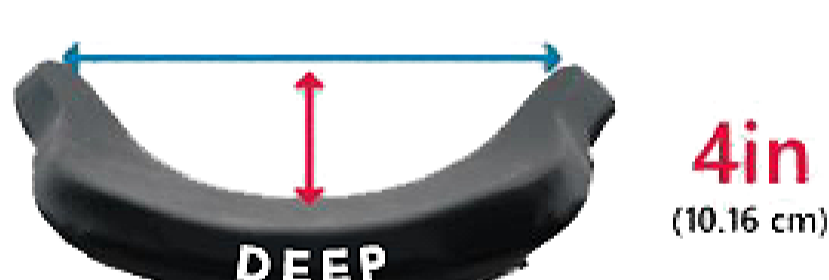

## PQ-365 NEWS • NEWS • NEWS • NEWS • NEWS • NEWS • NEWS

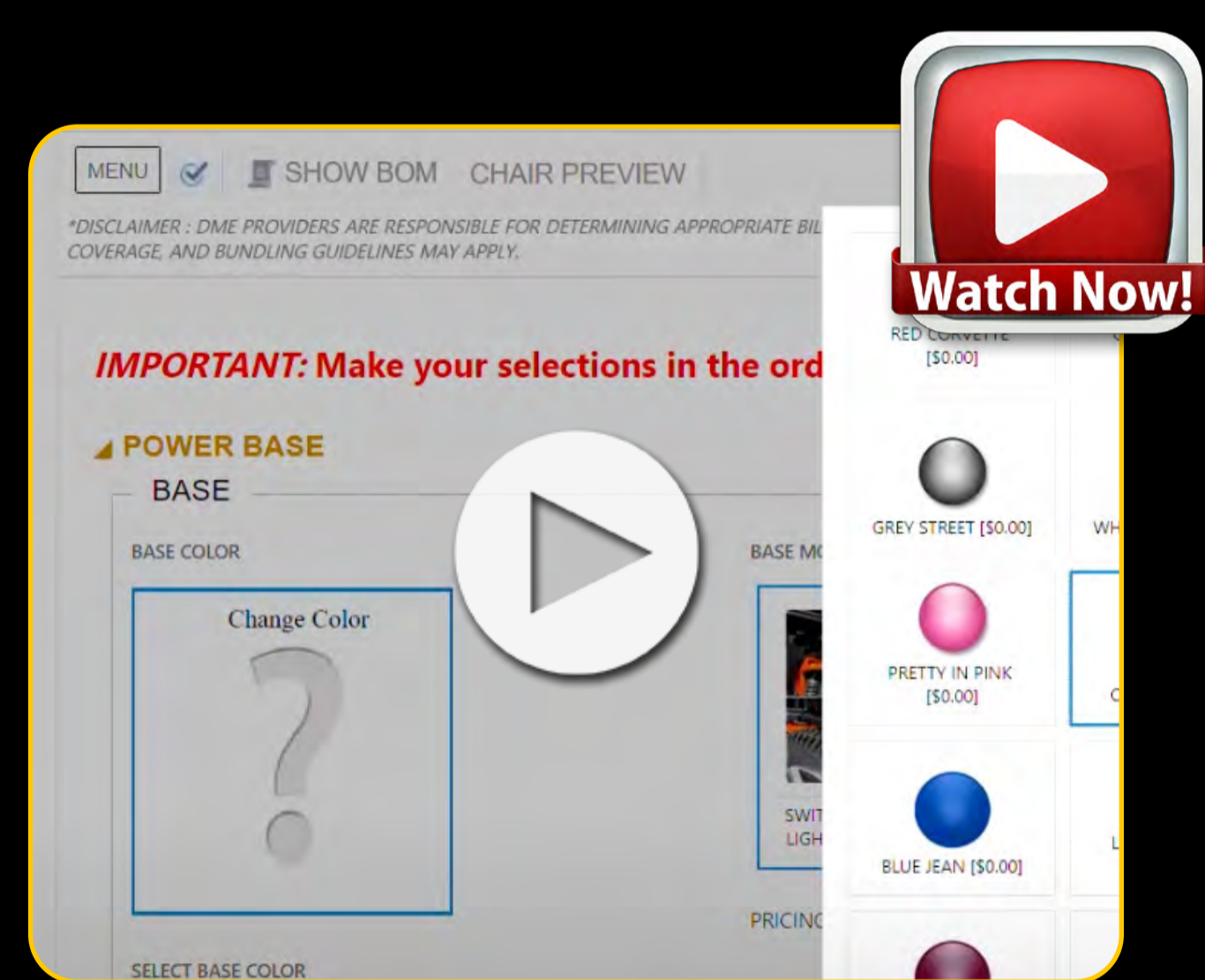

## Configure This

Use our PQ-365 Configure, Price, Quote (CPQ) tool for all your Quantum quoting and order needs. Log on to PQ-365.com and complete a Quantum® power chair order in 5 minutes or less!

 [CLICK HERE](#) to watch a tutorial demonstrating 5-minute quotes.

## Get Access with Group 2

The all-new Jazzy® EVO 614HD is available. Here's how this newly designed Group 2, Heavy Duty (K0824/K0825) power wheelchair benefits your clients.

- Ultra-comfortable high back memory foam captain seat with limited recline
- A single seat post allows the client to swivel for easy transfers in and out of the chair
- A 22" turning radius smoothly navigates tight corners
- Adjustable front and rear independent Active-Trac® ATX Suspension provides a smoother ride

 [CLICK HERE](#) to read more.



FDA Class II Medical Device